

Surface Mounted LED SMD Downlight



Product Features:

- Energy efficient Surface Mounted LED SMD Downlight available in various size and watts
- Quality aluminium profile adopted for durability and optimum heat dissipation
- Equipped with SAN'AN LED chip for long lifespan over 40,000hours
- Quality diffuser adopted for optimum glare control and light distribution
- Easy installation design via disk plate secured by screws from sides
- Available in White finish only
- Dimmable version available upon request
- 3 Year Replacement Warranty

Application:

- Commercial offices, shops and hotels
- Schools and hospitals
- Residential living room, lobby and balcony



Quick Spec

Luminous Efficacy: 95 lm/w

Color temperature: 3000k/4000k/5000k

Average rated LED life: 40,000hrs @ L70

Ambient temperature: -35°C to 45°C

Beam Angle: 60°

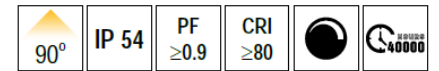
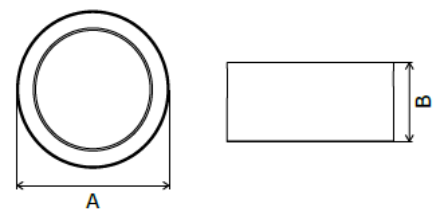

Model	Watts	Supply Volatage	Lumen Output	Dim (mm)	Weight	IP Rating
SL-DL52-8W	8W	AC220-240V,50Hz	760lm	Ø100*60	0.35kgs	IP54
SL-DL52-12W	12W	AC220-240V,50Hz	1150lm	Ø150*68	0.69kgs	IP54
SL-DL52-15W	15W	AC220-240V,50Hz	1425lm	Ø150*68	0.69kgs	IP54
SL-DL52-18W	18W	AC220-240V,50Hz	1750lm	Ø170*68	0.86kgs	IP54